

ProALARM is a failure indication device that alarms a user if a failed SPD needs replacement. It can be quickly and easily installed on the same rail next to the SPD by making a connection between the RC contact of the SPD and the RC contact of the alarm unit. In the case of a failed SPD, the user is alarmed by a loud audible beeping sound and the illumination of a red LED. This event can be acknowledged by pressing the button on the device; this will silence the audible sound but leave the LED illuminated until the failed SPD has been replaced.

ProALARM**130 511****IEC Electrical**

Rated Voltage (AC)	110V – 230V
Rated Frequency	50 Hz - 60 Hz
Rated Current (Beeping)	5 mA (110V); 10 mA (230V)
Overcurrent Protection (max)	16 A
RC Rated Current	5 mA (110V); 10 mA (230V)

Mechanical & Environmental

Operating Temperature Range	T_a	-20 °C to +70 °C (-4 °F to + 158 °F)
Mounting		35 mm DIN Rail, EN 60715
Degree of Protection		IP 20 (built-in)
Housing Material		Thermoplastic: Extinguishing Degree UL 94 V-0
Operating State/Display		Red LED / Audible Alarm
Weight	pounds [grams]	.19 [87]
DIN 43880 Dimension		1 TE / .71" [18]

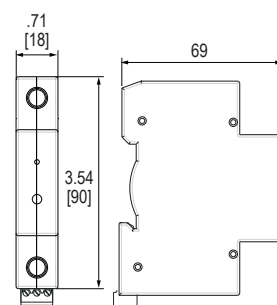
Dimensionsinches
[mm]**General**

- Verify the system voltage and configuration on the label to see if it is appropriate for the application.
- Risk of Electric Shock – Installation and maintenance should be performed by qualified personnel only.
- Mains voltage is present on a RC input of an energized ProALARM.
- Safety rules and regulations applicable to all devices connected to power lines should always be followed, as well as any National safety standards or regulations.
- The external mechanical integrity of the device must be checked before installation. Products with visible damage should not be installed.
- Use of this device is only permitted within the limits shown and stated in these installation instructions. Opening or tampering with the device invalidates the warranty.

Installation

- The unit can be connected to the mains supply, which is protected by protecting device with a maximum rated value of 16A (F1).
 - An external disconnect device that disconnects the device from the mains AC power is required. This unit shall meet IEC 60947 and need to be easily accessible and marked with suitable marks. Frequency 50-60 Hz.
 - RC input of ProALARM is connected to SPD RC output.
- ⚠** This RC input is hazardous mains voltage. Make sure the RC of the SPD is electrically compatible with RC of ProALARM (230V).

- If the unit is not used in the manner specified in these instructions, then the unit's degree of protection may be impaired.
- Connect RC output of SPD to RC input of ProALARM.
- Connect AC mains to power contacts of ProALARM.
- Always connect RC contacts first, then apply AC line voltage to ProALARM, to prevent from possible electric shock during wiring RC.
- ProALARM interface consist of a flashing light and a button.
- When ProALARM is in "alarm" state, the beeping sound can be turned off by pressing the button for 2 seconds. Red LED will glow until failed SPD is replaced.

